



# PRODUCT MANUAL CB-100

Memorable Scent  
Experiences from  
Clearly Better Scents™

## **Scent for Home & Business**

Scent Machines | Candles | Scenting via HVAC



# PRODUCT MANUAL

## CB-100

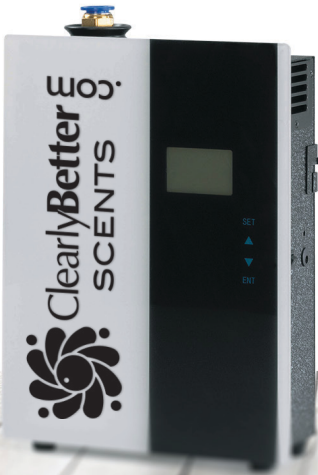

2

## INDEX

CAUTION .....	3
SPECIFICATION .....	4
OVERVIEW .....	5
DIRECTION .....	7
TIME SETTING .....	9
CONCENTRATION	
AND CONSUMPTION .....	11
EQUIPMENT CLEANING .....	12
NOTES .....	12
TROUBLESHOOTING .....	13
IMPORTANT NOTES .....	14

HVAC Systems Call 888.770.3434:

**Business • Hospitality • Travel • Entertainment**  
**Healthcare • Retail • Gaming • Property Management**



## CAUTION

Please comply with the following matters for safety use:



Do not modify, disassemble or repair the machine. If any failure occurs, please contact Clearly Better Scents.



Shall not damage the power cord, force to bend, yank, heavy load, clip or repro-cess.



Do not use the AC plug when it is damaged or un-matched with the socket;  
Do not wet the machine or the AC plug;  
Do not use overladen power socket, wire or broken plug.



Do not touch the wire or product shell when it is thundering or/and lightening.



Do not disassemble the machine when it is operating.

The above conditions may lead to fire, electric shock, short out or other failures.

Marketing programs built with Clearly Better Scents™ are designed to arouse the desired beneficial feeling and memory you want in your space-relaxation, stimulation, or comfort.

Visit  
[ClearlyBetterScents.com](http://ClearlyBetterScents.com)  
for scent fragrances selections.

# SPECIFICATIONS

Model	CB-100
Dimension	9" x 8.5" x 3.5"
Machine Wiegth	5.2 lbs
Voltage	Input: AC1 OOV-240V 50/60Hz Output: DC12V 1A (CB-100)
Power	10W
Technology	Twin-fluid atomization technology
Coverage	CB-100: 10,500 cubic feet
Bottle Capacity	150ml
Materials	Machine: Iron, Acrylic Bottle: PET Nebulizer: POM
Accessories	Plug, Bottle, connector tube, Mounting bracket, connector,tape, key, manual.

4

# OVERVIEW

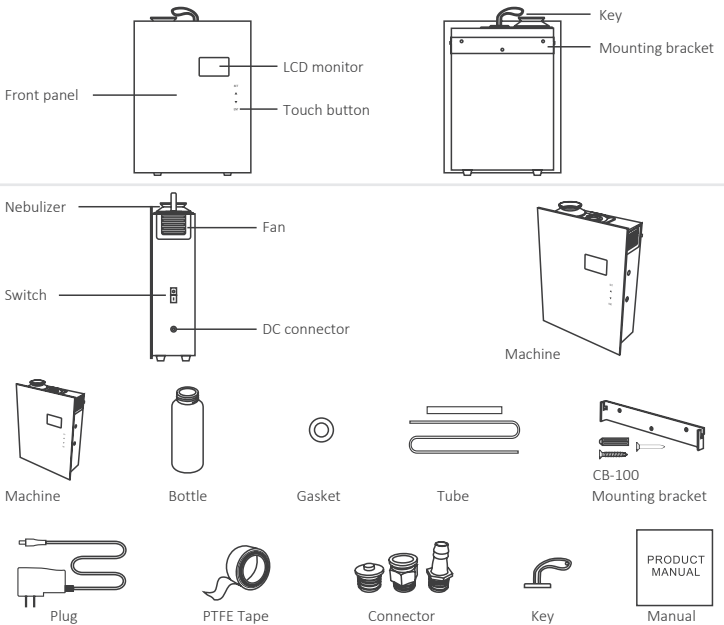

- PTFE Tape: 1. Tie up/ twine the atomized core when change a new one to machine.  
2. Twine connector screwing to machine.

Please confirm the completeness of your parcel. If there are any problems, please contact us within one month of receiving it.

# DIRECTIONS

Ideal for Hotels, Conference Rooms, Malls, Exhibition Halls, Major retailers, Bars, SPAs, Business places or anywhere you want a fragrance experience.

Bottle installation steps:

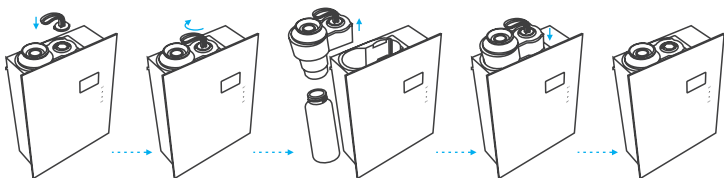

1. Insert the key.
2. Rotate the key 10 degrees clockwise to unlock
3. Unscrew and take out the atomized head. Fill the fragrance.
4. Insert the atomized head and bottle.
5. Take out the key.

Mount to the wall (CB-100):

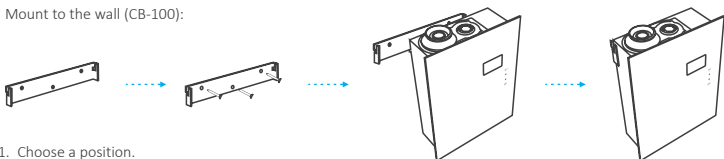

1. Choose a position.
2. Fasten the mounting bracket with nails.
3. Hang the machine.
4. Done.

6

# DIRECTIONS

How to use the expansion bolt:

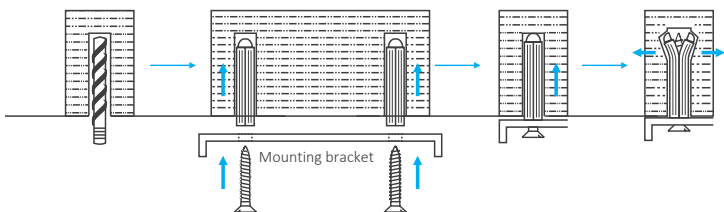

Drill the hole in the wall, insert the expansion pipe to the hole, put the screw into the expansion pipe and tighten.

# DIRECTIONS

Wall-mounted:



Floor:

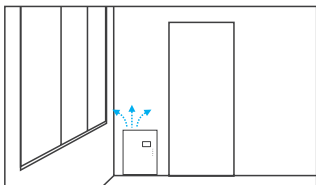

Tabletop placement:

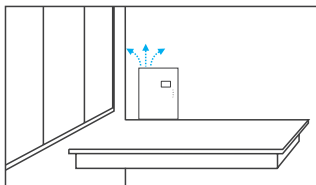

## Warning:

After installation, please keep the machine vertical. Tilting or placing it flat may cause an oil overflow.

The machine efficiency may be affected if the circuit board is contaminated.

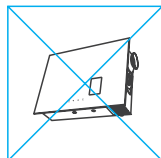
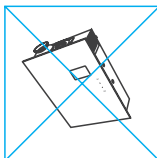

8

# TIME SETTING

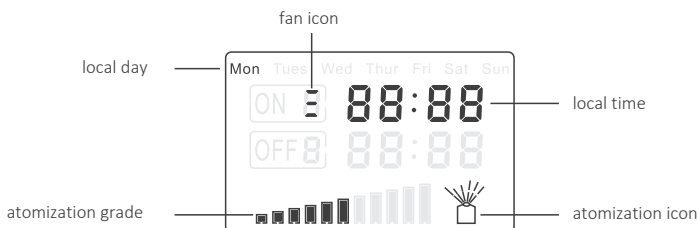

## Power on

Connect with power supply, turn on the switch (Figure 1), power-on noise comes out, screen lights on, which shows time and atomized grade.

## Power off

Turn off the switch (Figure 1), lights off and no display on screen.

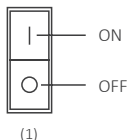

## Auto-lock

Screen will be locked automatically and no display after 1 minute if there is not any further manual manipulation.

## Unlock

Touch **SET** (about 5 seconds) comes out with noise "beep" and screen lights on to unlock machine.

## Fan

Touch **Fan** button (about 5 seconds) to turn on the fan, fan icon  displays on screen (Figure 2). Touch **Fan** button (about 5 seconds) to close fan.

Fan operating: Fan icon is displaying circularly under machine diffusion periods.

Fan stops working when machine is out of working periods, the fan icon displays as .

# TIME SETTING



(2)

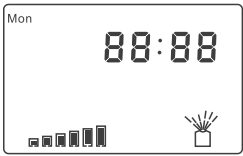

(3)

## Local Time setting

Touch **SET** button (about 5 seconds) till "beep" noise for local time setting. Touch ▼ to move to setting position.Touch ▲ to adjust local time, **ENT** to confirm (Figure 3).

## Diffusion time setting

There are 3 working periods available to be set for every day.

Touch **SET** button to check the working periods from Monday to Sunday, touch ▼ to choose working periods, touch ▲ to adjust setting numbers.



(4)

Day	Mon			Tues			...	Sat			Sun		
Touch time	1	2	3	4	5	6	...	16	17	18	19	20	21
Available working period	—	二	三	—	二	三	...	—	二	三	—	二	三
	00:00 00:00	00:00 00:00	00:00 00:00	00:00 00:00	00:00 00:00	00:00 00:00	...	00:00 00:00	00:00 00:00	00:00 00:00	00:00 00:00	00:00 00:00	00:00 00:00

(PS: The first working period is factory defaults with operating time 07:00 and closing time 21:00, the rest are all with 00:00.)

10

# CONCENTRATION AND CONSUMPTION

## Form 1 Atomization Concentration

Grade	Working(s)	Stop(s)
G10	400 Seconds	40 Seconds
G9	360 Seconds	80 Seconds
G8	320 Seconds	120 Seconds
G7	280 Seconds	160 Seconds
G6	240 Seconds	200 Seconds
G5	200 Seconds	240 Seconds
G4	160 Seconds	280 Seconds
G3	120 Seconds	320 Seconds
G2	80 Seconds	360 Seconds
G1	40 Seconds	400 Seconds

▲ up grade ▼ down grade

## Essential oil consumption

### Essential oil consumption

Consume (ml/h)											
	G1	G2	G3	G4	G5	G6	G7	G8	G9	G10	
CB 100: 150ml bottle	.17	.33	.49	.65	.80	1.00	1.20	1.40	1.60	1.82	

Note: Above data is based on the use of Clearly Better Scents™

# EQUIPMENT CLEANING

## The machine needs to be cleaned when the below situations happens:

1. You're about to change to another kind of essential oil;
2. The atomization volume becomes weak.

## Cleaning steps:

1. Find a clean bottle and fill it with rubbing alcohol.
2. Install bottle with rubbing alcohol into the machine and turn on the power. Let it run for 5-10 minutes.
3. Turn off the power, finish the cleaning.

## Tips:

You can use the machine directly after cleaning. There is no need to wash the tube again or wait until dry.

# NOTES

- Atomization icon displays on screen but the machine would not diffuse when it stays on pause time.
- It is invalid to touch/tap button when machine is under lock status.
- If the screen displays messy programs crash, please reset the machine by touching **"ENT"** button about 5 seconds till a short "beep" noise comes out.
- After installation, please keep the machine vertical. Tilting or lying flat may cause oil overflow.  
The machine efficiency may be affected if the circuit board is contaminated.

12

# TROUBLESHOOTING

Before asking to have the machine repaired, try to diagnose the problems by following the instructions.

1. Check if the power is on or off by flipping the switch in the side of the unit.
2. Ensure the diffuser head is seated flush with the edge of the unit. The diffuser head must be pressed down completely and flush to make proper air connection.
3. Again, flip the switch on the side of the machine OFF and back ON and see if the mist emits by holding your phone light to the top of the diffuser. If mist is emitting, the scent machine is running properly.
4. Remove the diffuser head and you will see an air-port inside of the unit on the right hand side facing the unit. See if the air-port is emitting air. If you feel the air and do not see the mist in step 3, then the diffuser head is likely clogged.
5. Reset the machine by holding the ENT button until you hear a beep. This will reset the machine back to its original settings and fixes any programming issues. (This step must be done as this usually solves the problem if it is not a clog).
6. When filling the scent bottle, we recommend filling it up about 80-90% full. At times, when the bottle is overfilled or filled to the top, the machine will gurgle as it cannot force air through the diffuser to pull the scent through the straw.
7. At times, the straw within the diffuser can get clogged with debris. Remove the scent from the bottle and fill with rubbing alcohol. Run the unit for about 10 minutes to break free the clog/debris. Remove the alcohol and rinse thoroughly with water. Repeat again by running the unit with water in the bottle.



...the art and science of scent marketing

Clearly Better Scents™ unique array of fragrances,  
candles and scent delivery systems are  
exclusively available for your home or business at

**Store.ClearlyBetter.com**



888.770.3434

To reorder go to: [store.clearlybetter.com](http://store.clearlybetter.com)